

Compact pulley and intermediate pulley

compact pulley in pulley set 6272-1000

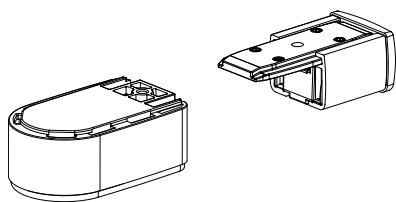

Set consisting of a motor pulley and a compact end pulley. The end pulley consists of a strengthened synthetic rail connector, a strengthened synthetic interior and an aluminium profile.

Placing the default end cap 6253 is optional.

Applicable with (recommendation):
see Load Capacity Table (page 7), under 6060-1.0

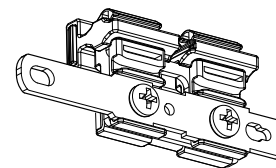

6275-3010

dimensions

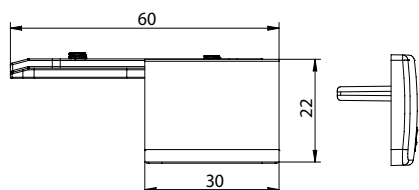

side view of the end pulley and also shown end cap 6253.
(measures in mm)



Example of an end pulley with default end cap 6253.



Special: optically non-interrupted rail in a corner.

compact intermediate pulley 6272-2000

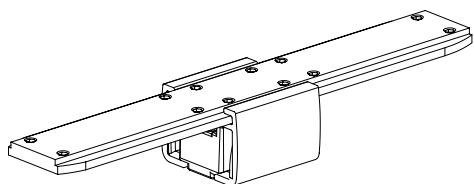

Compact intermediate pulley with steel bridge to be fitted inside a 6200 profile. The intermediate pulley consists of a strengthened synthetic interior and an aluminium profile. A virtually invisible intermediate pulley that creates an optically non-interrupted rail.

Applicable with:
Electric systems with asymmetric stacks that can be controlled individually.
See Load Capacity Table (page 7), under 6060-1.0. Regarding Load on both sides: each side of the pulley can be seen as an individual system.

dimensions

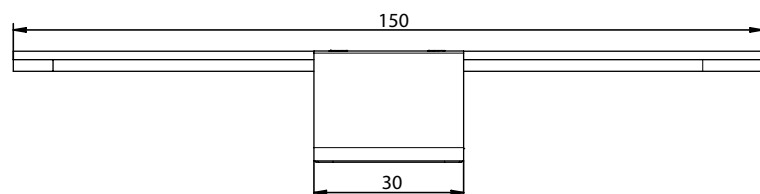

example



Application example of centre pulley 6272-2000

The rail is optically non-interrupted while still enabling the individual control of two curtain stacks of different lengths. It is also possible to control one stack manually and the other electrically.

