

Sustainable By Design

CASE STUDY: University Medicine and Dentistry of New Jersey, Newark, NJ



GOELST[®]

915 Bridge St.
Winston-Salem, NC 27101
Ph: 336.201.5555
Fax: 336.201.5556
www.goelst.com

“With Goelst, we were able to better organize our inventory and improve access and workflow.”

Victor Pardo
Operations Manager, University Medicine and Dentistry of New Jersey

GOELST[®]



CASE STUDY: University Medicine and Dentistry of New Jersey, Newark, NJ

“We needed to maximize our space. We needed furniture that would allow the use of every available square inch.” - Victor Pardo, Operations Manager

When asked what the worst problems were before the implementation of the Goelst® product, Victor Pardo simply replied, “Lack of organization, ease of use.” Now just over six months after the installation, Pardo describes the facility at University Medicine and Dentistry of New Jersey as “a clean, organized, and pleasant work environment.”

As a university of the health sciences and the largest institution of its kind in the nation, UMDNJ operates with challenges including limited space, 24/7 operation, and an extremely fast-paced work environment. Maintaining a high level of organization and efficiency is an absolute must. After teaming with veteran Goelst design engineer, Vinnie Gautieri, Pardo was impressed with how Goelst was able to “successfully increase storage capacity and organization of our inventory, including providing unique storage for our cassettes.” Specifically, Goelst was able to “customize our limited available space in a way that made everything easier to find.”

Because of UMDNJ’s 24/7 operation, Goelst needed to and was able to install new furniture in “shifts,” effectively minimizing the effect on work flow. The institution never closed its doors and was able to function smoothly during the transition and upgrade. Pardo notes that the entire organization is excited about having “a pleasant work environment, which has already led to increased productivity.”

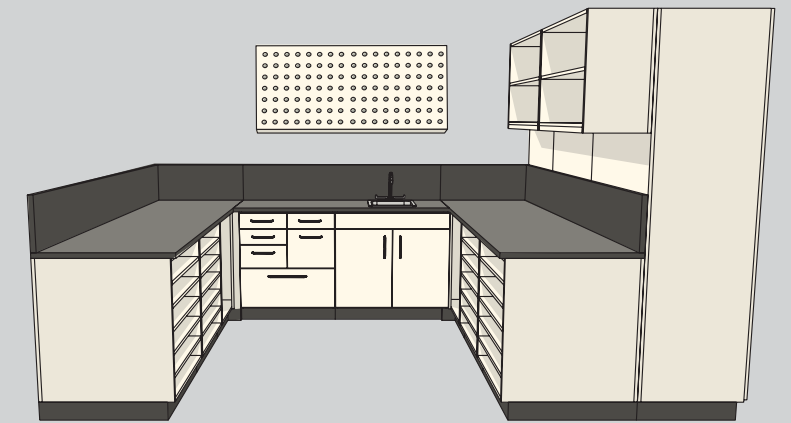

Beyond Increased Organization

In addition to concerns of organization, Pardo was looking for a product that delivered functionality, durability, and great aesthetics. After reviewing many finish options, the team at UMDNJ decided on a popular Goelst® anigre woodgrain for their pharmacy and nurses’ station areas, and opted for a “fog” grey finish in the lab areas. In order to defend against fluid contamination, the team also decided to use Trespa® and Corian® worktops where necessary, which were not only critical for safety reasons, but also blended well aesthetically with the Goelst® laminate selections.

Goelst delivered a smooth implementation and transition, a service-oriented design engineer who was called “the key to the project,” and product that met UMDNJ’s needs of functionality, durability and aesthetics. When asked if he would choose to work with Goelst again if given the opportunity, Pardo delivered a one-word answer: **“Absolutely.”**

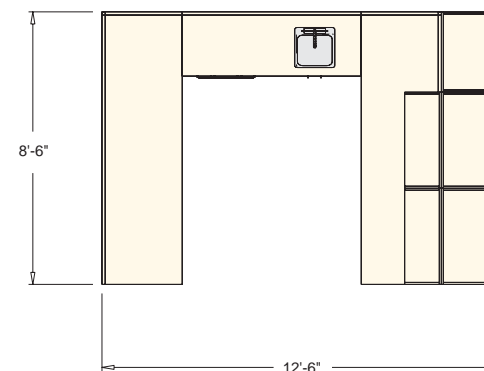

QUICK LOOK

OVERALL SIZE: 4,900 Square Feet

AREAS INCLUDE: Main Pharmacy, Satellite Pharmacy, Laboratory, Nurses’ Stations, Locker Area

PRODUCT USED: Goelst® Anigre woodgrain laminate cabinet bodies and fronts in pharmacy, locker, and nurses’ station areas. Goelst Fog laminate on lab bodies and fronts. 3mm edge-banding on laminate worktops, cabinet fronts and bodies

WORK SURFACES: Trespa® in laboratories, Corian® on nurses’ stations, Goelst laminate in pharmacies



PICTURE INDEX (CLOCKWISE FROM TOP LEFT): 1 PHARMACY WORK AREA; 2 LAB AREA WITH FOG LAMINATE CABINET BODIES AND TRESPA® WORKTOPS; 3 PHARMACY WORK AREA PERSPECTIVE LINE ART; 4 LAB AREA DRAWER SHOT; 5 PLAN VIEW LINE ART OF PHARMACY WORK AREA; 6 PHARMACY PRODUCTION AREA