



**GOELST**<sup>®</sup>

915 Bridge St.  
Winston-Salem, NC 27101  
Ph: 336.201.5555  
Fax: 336.201.5556  
www.goelst.com

“The Goelst experience was superior...It has a casework look with modular capabilities.”

**Rodney Casebier**  
Project Manager of Capital Planning and Projects

**GOELST**<sup>®</sup>



**CASE STUDY: UMC Medical Center, Tucson, AZ**

“It has a casework look with modular capabilities” - Rodney Casebier, Project Manager of Capital Planning and Projects

When it was time to replace the nursing station on 4 West, University Medical Center chose Goelst to provide a turnkey solution for the new unit. “The Goelst® product is well made and durable. It has a case-work look with modular capabilities, and the warranty is one of the best in the industry” says Rodney Casebier, project manager of capital planning and projects.

**“Visibility” was the Key Term**

During the needs assessment, it became clear that “visibility” was the key term. The nurse station needed to be located in the center of the patient units to allow visible access to each room without leaving the station. This design criterion posed a unique problem; no drop-downs could be used for utility chases as this would hinder the visibility. In addition, the utilities had to be housed in a unit that allows for future expansion of data, electrical, and plumbing services without shutting down the station. The Goelst solution

was to use the Goelst® hollow wall unit. This product, when fitted with a glass partition, allows full visibility and has removable exterior panels. The removable panels allow for easy access for any future expansion of services.

Another unique solution was provided for the storage of carts. The carts must be quickly available, yet hidden from the patient’s view. The Goelst solution was a garage cabinet. This specialized cabinet allows the cart to roll inside and be hidden behind doors. When closed, the cabinet blends into the facade and provides a finished appearance, yet can be accessed very quickly during emergencies.

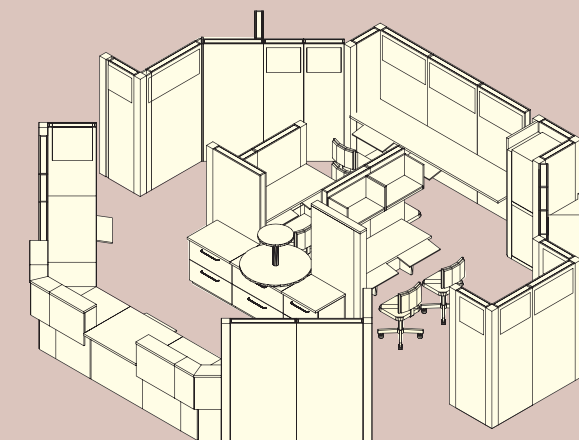

**Proactive Goelst Team**

Working closely with the end-users, the Goelst designer developed an innovative solution that created a highly efficient work environment, addressed HIPAA, future expansion, visibility, and provided the aesthetics needed in today’s patient areas. The product provides storage and spatial options not found in most modular lines; this enables us to design with fewer limitations and provide work areas that address the staff needs. Our footprint for the nurse station was a polygon with data and electrical sleeves that were fixed. Goelst designers and installers worked to get the product to fit the space constraints without compromising productivity.

The end result was a high-end, built-in look; yet the complete station is modular and reconfigurable allowing the end-user the flexibility to adjust as their needs change. “At all stages the Goelst experience was far superior to the previous nurse station provider. Goelst customer service is excellent; all of the Goelst team is proactive when solving problems. Yes, I will be using Goelst again,” said Casebier.

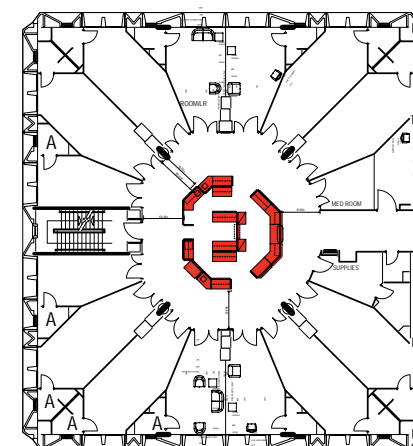

**QUICK LOOK - 4th Floor W. Nurse Station**

OVERALL SIZE: 440 Square Feet; 25ft x 22ft

AREAS INCLUDE: Records (4); Telemetry (2); Charting (2); general work area (5)

PRODUCT USED: Goelst® medium cherry wood-grain laminate with matching 3mm edgebanding

WORK SURFACES: Graphite Spectrum laminate with black 3mm edgebanding

HIGHLIGHTED PRODUCTS USED: Goelst® Segmented Hollow Wall units with glass partitions (20SHW). Garage units for cart storage (14GEC)



PICTURE INDEX (CLOCKWISE FROM TOP LEFT): 1 BUILDING FACILITY AND GROUNDS; 2 INTERIOR OF NURSES’ STATION AREA; 3 LINE ART OF NURSES’ STATION AREA; 4 STORAGE FOR MEDICAL CARTS; 5 LINE ART OF PARTIAL FLOOR PLAN, NURSES’ STATION AREA COLORED; 6 FRONT DESK OF NURSES’ STATION